

## product & accessory

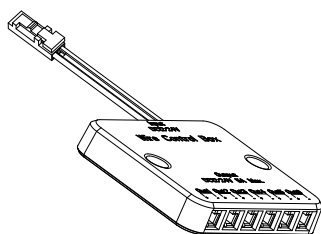

1\* wireless receiver

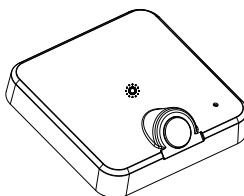

1\* wireless emitter of PIR sensor with touch dimmer



1\* screw



1\* magnet piece

A1

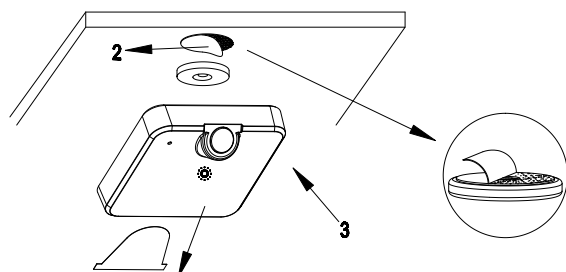

1. take off insulation sheet of battery
2. Fix the magnet piece onto the board with 3M tape
3. Stick the emitter onto the board with magnet piece

A2

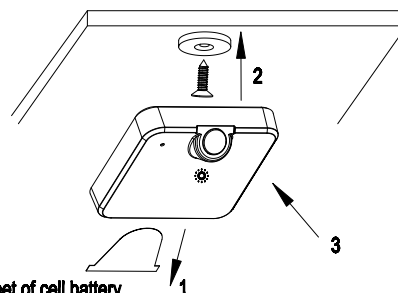

1. take off insulation sheet of cell battery
2. Fix the magnet piece onto the board
3. Stick the emitter onto the board with magnet piece

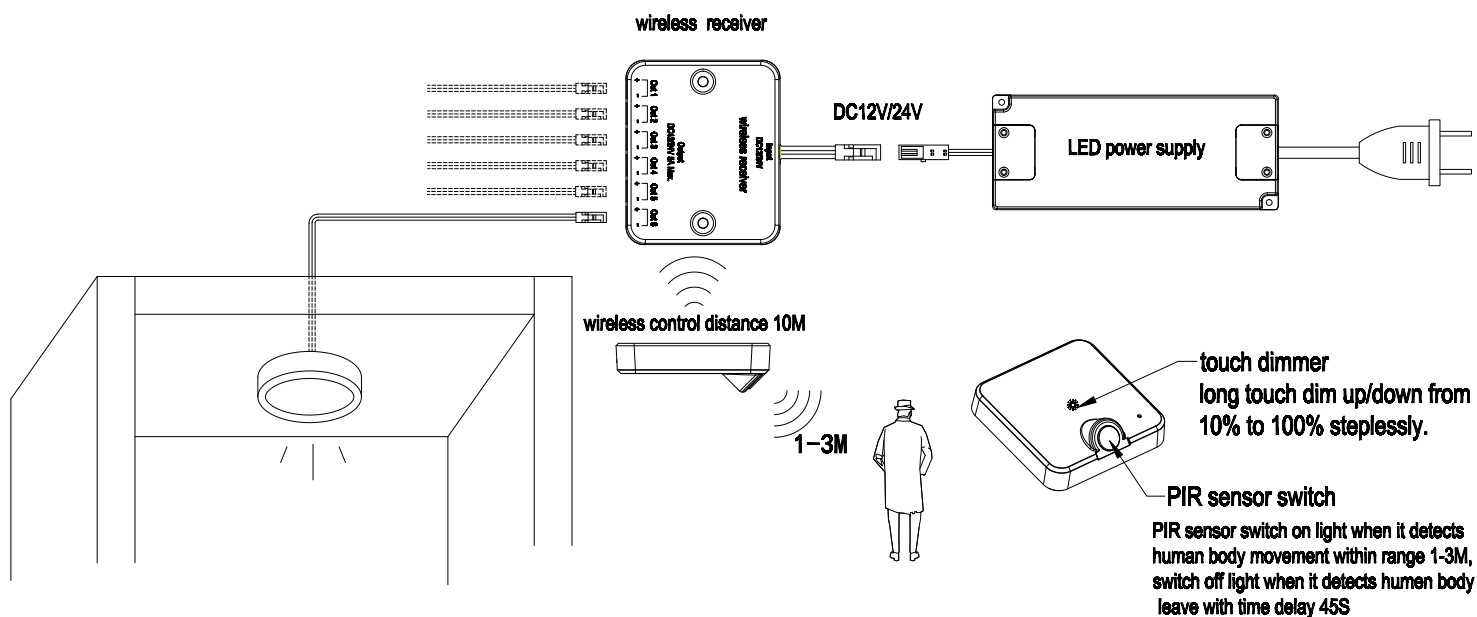

## pairing/unpairing

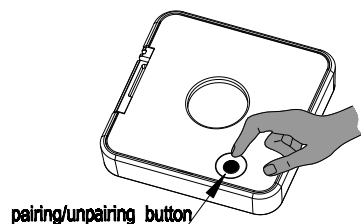

1. Pairing: Press the pairing button on the remitter within 3seconds after receiver connected to the power supply, it's successfully paired when the output light flash three times.
2. Unpairing: Long press(over3S) the pairing button on the remitter within 3seconds after receiver connected to the power supply, it's successfully unpaired when the output light flash three times.
3. One receiver can be paired with multiple emitters, one emitter can be paired with max. eight receivers. (one receiver and one emitter already paired in production, pls do the multiple pairing and unpairing by yourself.)

## Battery change

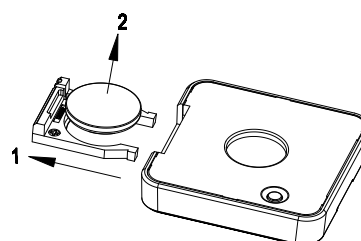

Indicating light quickly flashes when battery is low

1. Pull out the battery box
2. Change a new CR2032 cell battery